



JANATA SHIKSHAN PRASARAK MANDAL'S
MARUTRAOJI GHULE PATIL ART'S, COMMERCE AND SCIENCE COLLEGE,
Dist-Ahmednagar, Pin- 414111 (Maharashtra)



Assessment and Accreditation Document

1st cycle

A.Y. 2017-2018 to 2021-2022

4. Infrastructure and Learning Resources

K.I's 4.1: Physical Facilities

4.1.1 Availability of adequate infrastructure and physical facilities viz., classrooms, laboratories, ICT facilities, cultural activities, gymnasium, yoga center etc. in the institution



4.1.1 Availability of adequate infrastructure and physical facilities viz., classrooms, laboratories, ICT facilities, cultural activities, gymnasium, yoga center etc. in the institution

Index

Sr. No.	Documents	Page No.
1.	Details of College Campus	4
2.	College Map and Location	6
3.	7/12 and 8A document of campus	7
4.	Campus Plane	9
5.	Details of College Buildings	10
6.	Sport Grounds Detail	12
7.	Photos of Physical Facilities	15
	A. Photos of Gymkhana and Sport Activities	15
	B. Ramps for Divyangjan Student Details	17
	C. Facilities for Gymkhana, sports, games (indoor, outdoor)	18
	D. Seating arrangement in campus for student	19
	E. Details of Toilet Facility	20
	F. Canteen	21
	G. Administrative Office	22
	H. Library	25
	I. Wi-fi facility	27
	J. ICT facility	28
	K. CCTV	30
	L. Solar lamp	31
	M. Botanical Garden	32
	N. Sick Room	34
	O. Physical Director Cabin	35
	P. Security Cabin	36
	Q. Generator Set	37
	R. Parking Shed	38
	S. Store Room	39
	T. Vermicompost	40
8.	Maintenance policy	41
9.	Facilities for cultural Activity	41
	I. Seminar Hall	41
	II. Amphitheater	42
10.	Vendors list for maintenance	43
11.	Space For Yoga	44



1. Details of College Campus:

Sr. No.	Particular	Qty	Dimensions in meter	Dimensions in Sq. meter	Dimensions in Sq. Foot	
1.	Total Campus area built-up			2906.209	31282.17	
2.	College Gate	1	9.50x2	19	204.5143	
3.	College canteen	1	7.60x3.70	28.12	302.6812	
4.	Vehicle Parking Stand	1	31x07	217	2335.769	
5.	Botanical Garden	1	52.80x9.70	512.16	5512.844	
6.	Cactus Garden	1	6.10x4.70	28.67	308.6013	
7.	Vermicompost	1	4.30x3.20	13.76	148.1114	
8.	Main Academic and Administrative Building	1	53.69x23.23	1247.2187	13424.95	
	Sr. No.					
	Department					
	1.	Principal Cabin	1	4x5.7	22.8	245.4172
	2.	Administrative Office	1	7x11.4	79.8	858.9601
	3.	Toilet and Latrine for Staff	1	3x4	12	129.1669
	4.	IQAC Room	1	5.5x2.5	13.75	148.0038
	5.	ICT Classroom	1	7.35x9.58	70.413	757.9192
	6.	Store and Record Rooms	2	3.65x2.35	8.5775	92.32744
	7.	Examination Hall	1	7.35x9.58	70.413	757.9192
	8.	Total Classrooms	8			
	9.	Classroom no.2	1	7.25x9.58	69.455	747.6074
	10.	Classroom no.3	1	7.29x9.58	69.8382	751.7321
	11.	Classroom no.4	1	7.25x9.58	69.455	747.6074
	12.	Classroom no.5	1	7.68x9.58	73.5744	791.9483
	13.	Classroom no.6	1	7.35x9.58	70.413	757.9192
	14.	Classroom no.7	1	7.35x9.58	70.413	757.9192
	15.	Classroom no.11	1	3.70x9	11.1	119.4794
	16.	Library	1	7.32x9.58	70.1256	754.8257
	17.	Waiting Area Porch	1	3x6	18	193.7504
	18.	Toilet and Latrine for Physically Disabled	1	1.8x2.1	3.78	40.68758
	19.	Toilet and Latrine for Male Students	1	7.31x9.73	71.1263	765.5971
	20.	Toilet and Latrine for Female Students	1	7.31x9.73	71.1263	765.5971
	21.	Departments for all Arts faculties	4	3.70x9	33.3	358.4382
	22.	Common Staff Room	1	4.60x3.40	15.64	168.3476
	23.	Department of	1	4.60x3.40	15.64	168.3476



		Commerce				
	24.	Lab & Department of Zoology	1	11x9.10	100.1	1077.467
	25.	Lab & Department of Botany	1	11x9.10	100.1	1077.467
	26.	Lab & Department of Computer Science	1	7.90x9.20	72.68	782.321
	27.	Lab & Department of Physics	1	11.20x9.60	107.52	1157.336
	28.	Seminar Hall	1	11x9.60	105.6	1136.669
	29.	Ladies Rest Room	1	6.70x3.20	21.44	230.7782
	30.	Lab & Department of Chemistry	1	12x9.30	111.6	1201.252
9.	Gymkhana					
	Sr. No.	Grounds				
	1.	Volleyball Ground	1	18x9	162	1743.753
	2.	Kho-Kho Ground	1	27x16	432	4650.009
	3.	Kabaddi Ground	1	10x13	130	1399.308
10.	Sick Room		1	3x3.8	11.4	122.7086
11.	NSS Office		1	2.35x3.65	8.5775	92.32744
12.	Amphitheater		1	4.65x10.50	47.88	515.376
13.	Ground Porch		1	11.67x7.26	84.7242	911.9637
14.	First floor Porch		1	11.60x4	46.4	499.4454
15.	Main Stair case		1	4.2x8.02	33.64	362.0979
16.	Lift Area		1	1.8x2.1	3.78	40.68758
17.	Physical education office		1	3.8x3	11.4	122.7086
18.	Gymkhana		1	12x5.7	68.4	736.2515
19.	Stair 2		1	3.59x6.97	25.02	269.313
20.	Security Cabin		1	3x2	6	64.5835



2. College Map and Location



Google Map for College 1

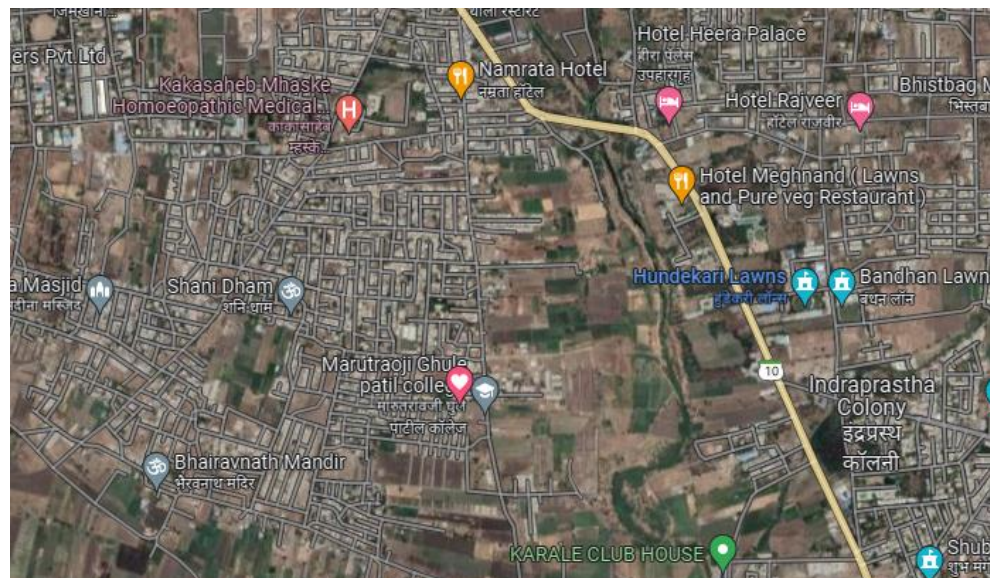



Google Map for College 2

- Google map link:
<https://goo.gl/maps/6ny63d5xw2PNqKVc9?coh=178573&entry=tt>
- Google earth link :
https://earth.google.com/web/search/Ahmednagar,+Maharashtra/@19.13122564,74.71457019,686.67132568a,0d,60y,292.22184348h,83.13080477t,0r/data=CigiJgokCXaD5_OLzTRAEdyBat12hzNAGUxrm5W9UINAaGasNInnVJAihoKfKfoejIDViytb0JTdE95M2NEUnpraUEQAg
- College Website Contact us:
<https://mgpcollege.com/contact/>



3. 7/12 and 8A document of campus

3.1 7/12 document

 महाराष्ट्र शासन गाव नमुना सात (अधिकार अभिलेख पत्रक) [महाराष्ट्र जमीन महसुल अधिकार अभिलेख आणि नोंदवही (तयार करणे व सुस्थितीत ठेवणे) नियम १९७१ यातील नियम ३,५,६ आणि ७]							
गाव :- मोल्डेमंत्र (१६४२६१)		तालुका :- नगर		जिल्हा :- अहमदनगर		 19941262556	
ULPN : 19941262556		गट क्रमांक व उपविभाग ८४/४					
भूधारणा पद्धती भोगवट्यादार वर्ग-१				शेताचे स्थानीक नाव :			
क्षेत्र, एकक व आकारणी	खाते क्र.	भोगवट्यादाराचे नाव	क्षेत्र	आकार	पो.ख.	फेरफार क्र	कुळ, खंड व इतर अधिकार
क्षेत्राचे एकक हे.आर.पौ.मी	१२८७३	[मकरंद साधव कुलकर्णी]				(१३८३३)	कुळाचे नाव व खंड
अ) लागवड योग्य क्षेत्र	१२८७४	जनता शिक्षण प्रसारक मंडळ करिता				(१७९७)	इतर अधिकार
जिरायत १.२१.००		प्रशासकीय अधिकारी				(१७९७)	प्रलंबित फेरफार : नाही.
बागायत -		कुंडलिक कडु पवार					
एकूण		-----सामाईक क्षेत्र-----	०.८१००	२.८१			
ला.पौ. क्षेत्र १.२१.००		जनता शिक्षण प्रसारक मंडळ दहिगावने	०.४०.००	१.३९		(१३८३३)	शेवटचा फेरफार क्रमांक : १३८३३ व दिनांक : ०९/१०/२०१९
ब) पोटखराब क्षेत्र (लागवड अयोग्य)		ता.शेवगाव जि.अहमदनगर करीता अख्यक्ष नरेंद्र मारुतराव घुले					
वर्ग (अ) -							
वर्ग (ब) -							
एकूण							
पो.ख.क्षेत्र ०.००.००							
एकूण क्षेत्र (अ+ब)							
१.२१.००							
आकारणी ४.२०							
जूडी किंवा आकारणी विशेष							
जुने फेरफार क्र : (८३७) (१०९४) (१९८६) (१९८७) (१७९६) (१७९७)							सीमा आणि भुनापन चिन्हे



हा गाव नमुना क्रमांक ७ दिनांक १५/१०/२०२१ १०:३२:१२:३५ PM रोजी डिजिटल स्वाक्षरीव केला आहे व गाव नमुना क्रमांक १२ चा हेटा स्वयंमामिब असल्यापुढे ७/१२ अधिकारपर पर कोमल्याती सती शिक्क्याची आवश्यकता नाही.

७/१२ डाउनलोड दि. : ०८/०७/२०२१ : १७:३३:०४ PM, शैला पडताळणीसाठी <https://dgt.watara.mahatrust.gov.in/oh/> या संकेत स्थळपर जाऊन 2609100001314331 हा क्रमांक वापरता.

पृष्ठ क्र. १/२





3.2 8A Document:

गाव नमुना बारा (पिकांची नोंदवही)											
[महाराष्ट्र जमीन महसूल अधिकार अधिलेख आणि नोंदवही (व्यापार करणे व सुस्थितीत ठेवणे) नियम १९७१ यातील नियम २९]											
गाव :- बोल्हेगाव (१४४२६९)			तालुका :- नगर				जिल्हा :- अहमदनगर				
गट क्रमांक व उपविभाग			८४/४								
वर्ष	हंगाम	खाते क्रमांक	पिकाखालील क्षेत्राचा तपशील					लागवडीसाठी उपलब्ध नसलेली जमीन		शेरा	
			पिकाचा प्रकार	पिकांचे नाव	जल सिंचित	अजल सिंचित	जल सिंचनाचे साधन	स्वरूप	क्षेत्र		
(१)	(२)	(३)	(४)	(५)	(६)	(७)	(८)	(९)	(१०)	(११)	
२०२०	संपूर्ण वर्ष								वस्तीपड	०.०००१	
२०२२	रब्बी	१२८७४*	निर्मळ	हरभरा	०.८१००			मोअरवेल			

टीप : * सदरची नोंद मोबाइल ॲप द्वारे घेणेत आलेली आहे



4. Campus Plane

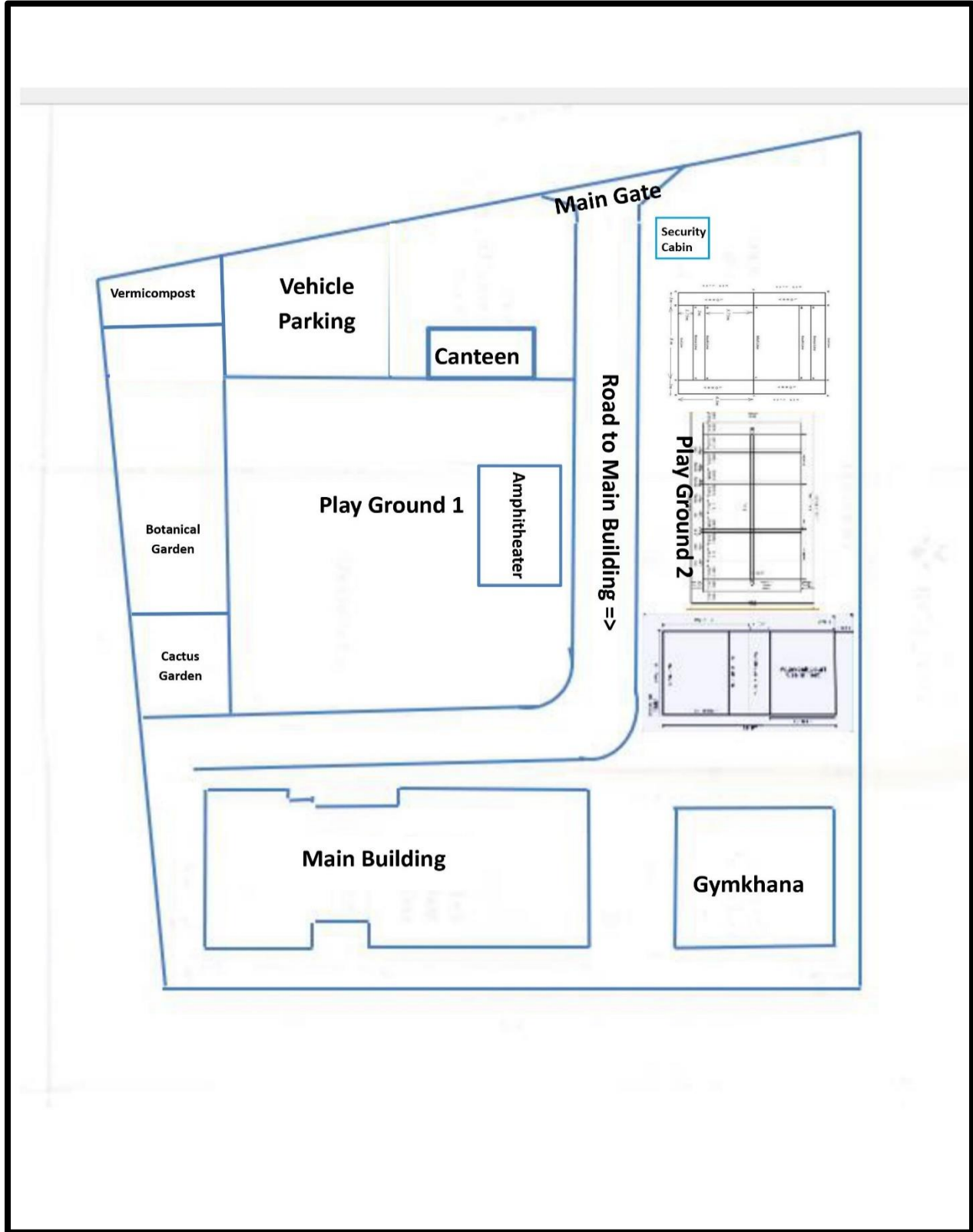



5. Details of College Building-

5.1. Ground Floor:

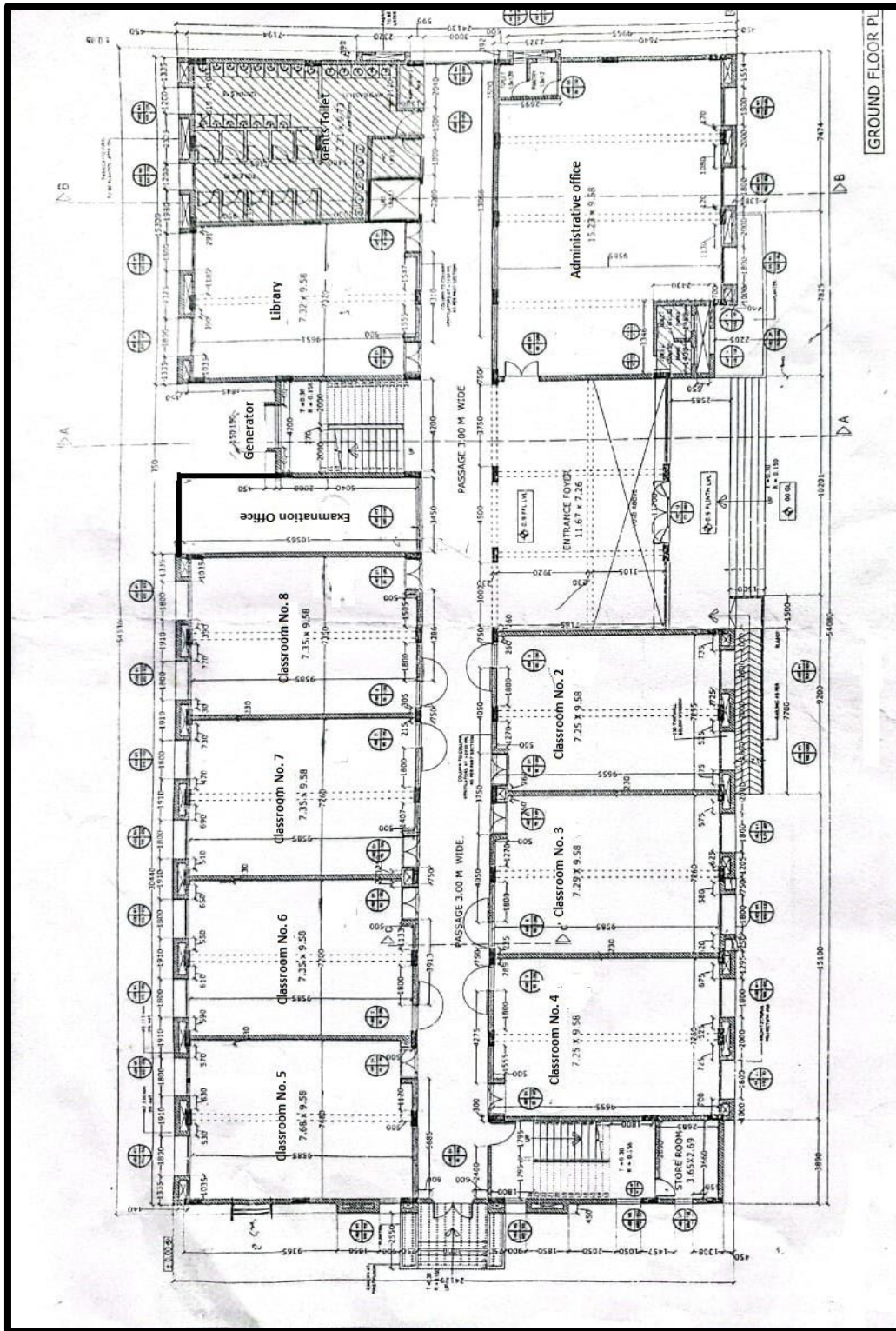



5.2 First Floor:

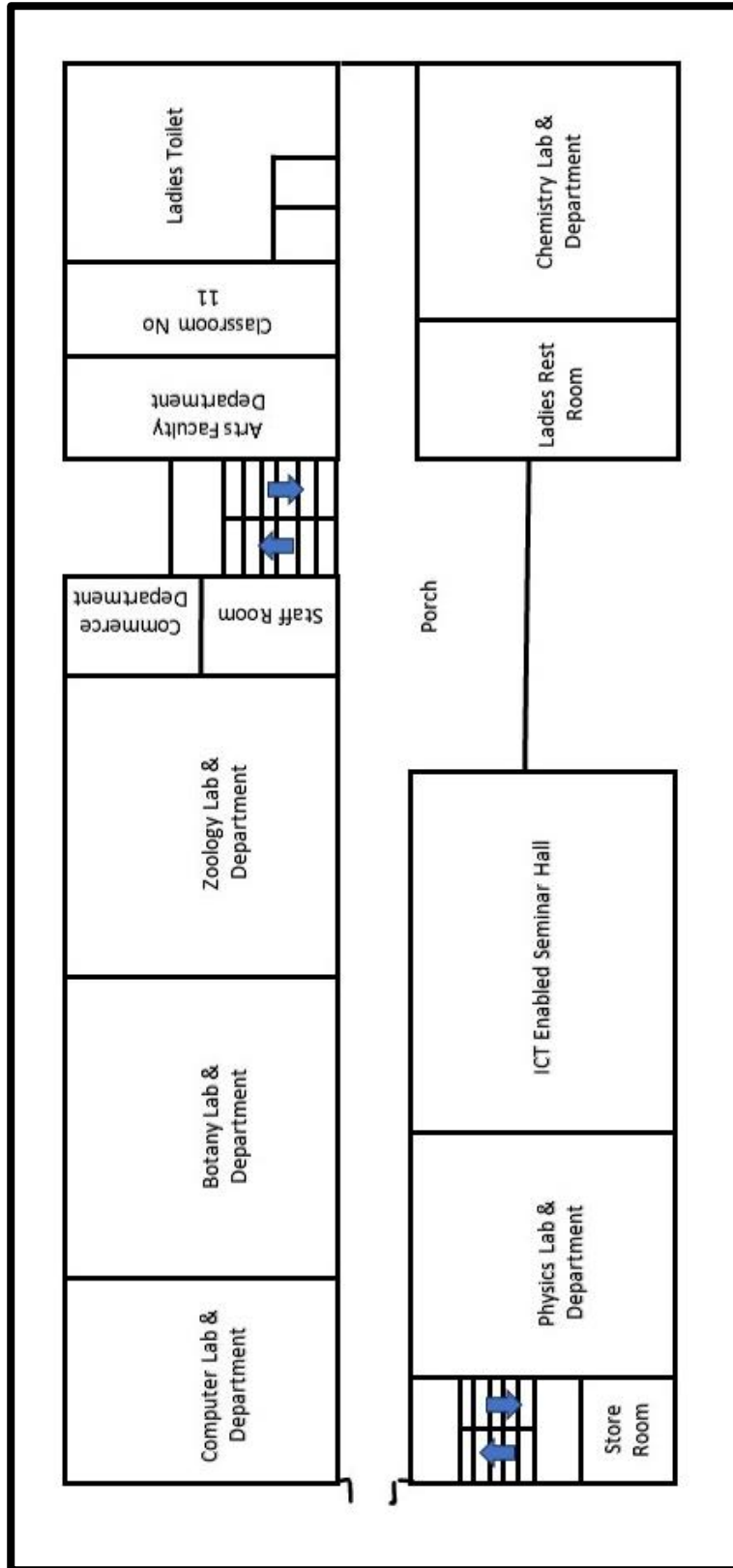



6. Sport Grounds Detail

Sr. No.	Ground Name	Dimensions in meter	Dimensions in Sq. meter
1.	Volleyball Ground	1	9x18
2.	Kho-Kho Ground	1	16x27
3.	Kabaddi Ground	1	10x13

6.1 Volley ball Ground:

Court: 18 meters long and 9 meters wide
 Centre: 9 m × 9 m halves by a one-meter
 Top of the net: 2.43 meters
 Centre line: 5 meters
 Serving Arena: 3 meters

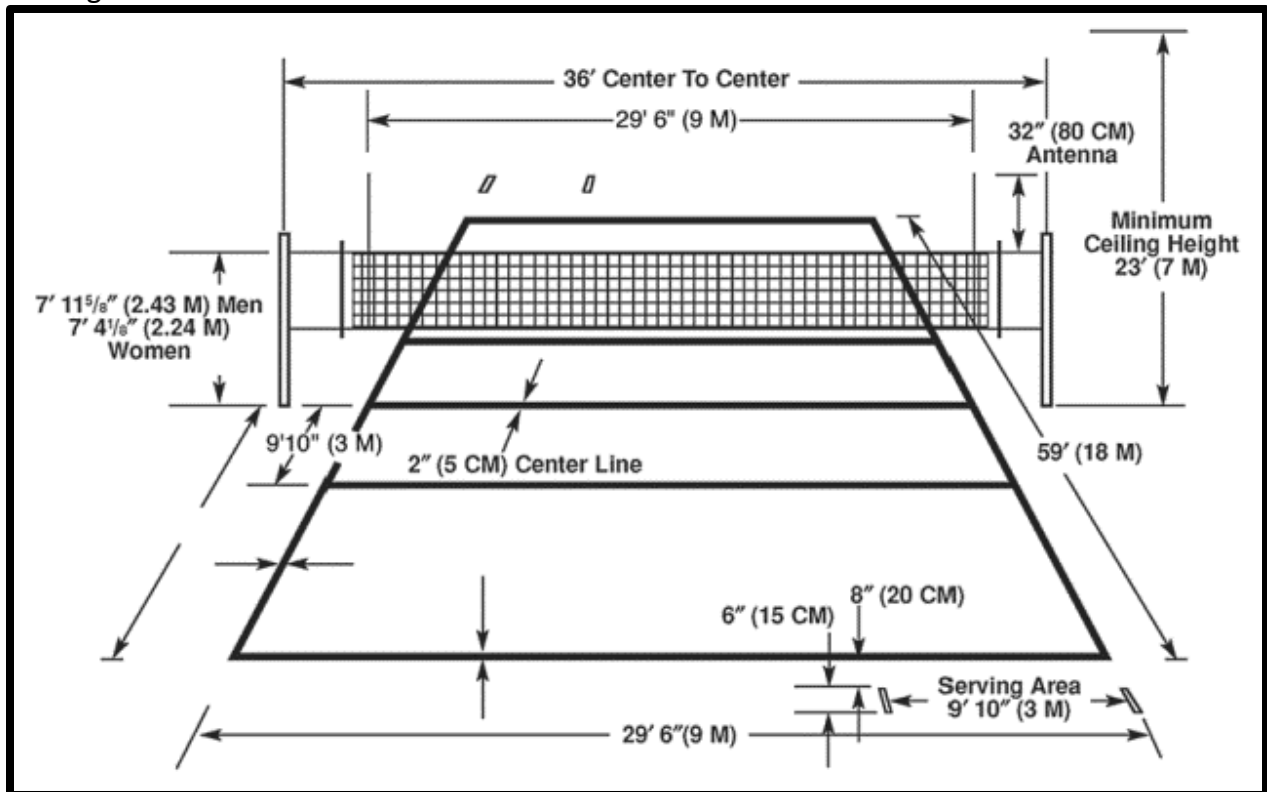

- [Geotagged Photo of Volleyball ground - link](#)



6.2 Kho-Kho Ground

- Total area requirement 30m x 19m (inclusive of lobby from all sides measuring 1.5m wide.)
- Playing Area 27m x 16m inclusive of 1.5m x 16m of free zone behind both poles
- Pole Distance 24m Central lane joining two poles measuring 24m length x 30cm width
- Cross lanes 8 nos. intersecting the central lane. Each lane measuring 16m x 35m
- Pole Size - Height (above ground level - 120cm to 125cm, Diameter 9-10cm.)
- The game comprises two teams with 12 players each (as per the rules of the Asian Kho-Kho Federation 15 players each) in the team while only 9 players actually playing.
- The match comprises 4 turns consisting of two defense and two chase turns.
- Every turn is of 9 minutes duration.
- Every put- out defender brings one point to the chasing team.
- The high scoring team is declared as the winner.
- The game consists of numerous defense as well as chasing skills
- Defense: Single chain, double chain, ring game, dodging and faking
- Chasing: running dives, pole dives, deceiving (judgment) Kho on the pole, delayed Kho, moving into cross lanes, etc.

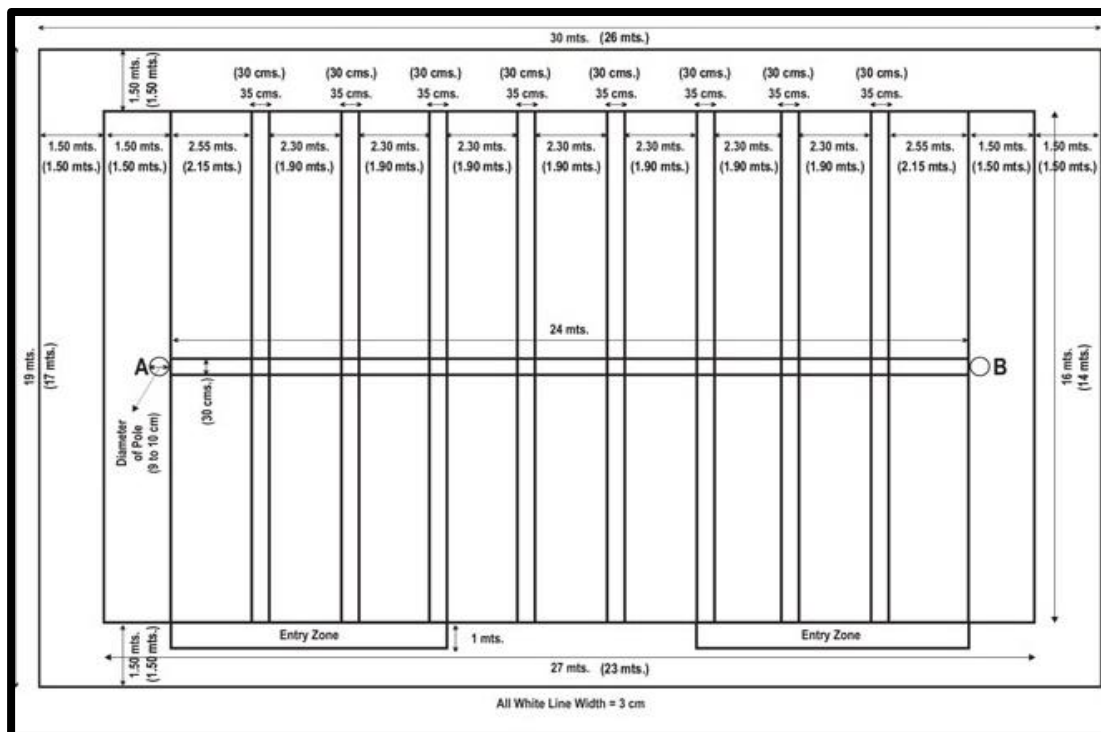

- [Geotagged Photo of Kho-Kho Ground- link](#)



6.3 Kabaddi Ground

- Dimensions: A standard kabaddi ground typically measures 13 meters in length and 10 meters in width.
- Boundary Lines: The playing area is marked by boundary lines, which form a rectangular shape. The lines themselves are considered to be part of the playing area.
- Midline: The ground is divided into two halves by a midline, which runs parallel to the shorter sides of the rectangle. This line separates the territory of each team.
- Baulk Line: Each half of the ground is further divided by a baulk line, located at a distance of 3.75 meters from the midline. This line determines the starting point for raiders during a raid.
- Bonus Lines: Additional lines known as bonus lines are marked parallel to the midline. They are situated 3.75 meters away from each side of the midline. If a raider successfully crosses the bonus line, their team earns extra points.
- Lobbies: On either side of the playing area, there are two lobbies. These are the zones where defenders wait for the raider to enter their territory.
- Out-of-Bounds Areas: The boundary lines themselves are considered out-of-bounds areas. If any part of a player's body touches or crosses the boundary lines during the course of play, they are considered out of the game.
- Safety Zones: At each end of the ground, there are safety zones marked outside the boundary lines. These zones are designated for players who are not actively participating in the game but need to be off the field temporarily.

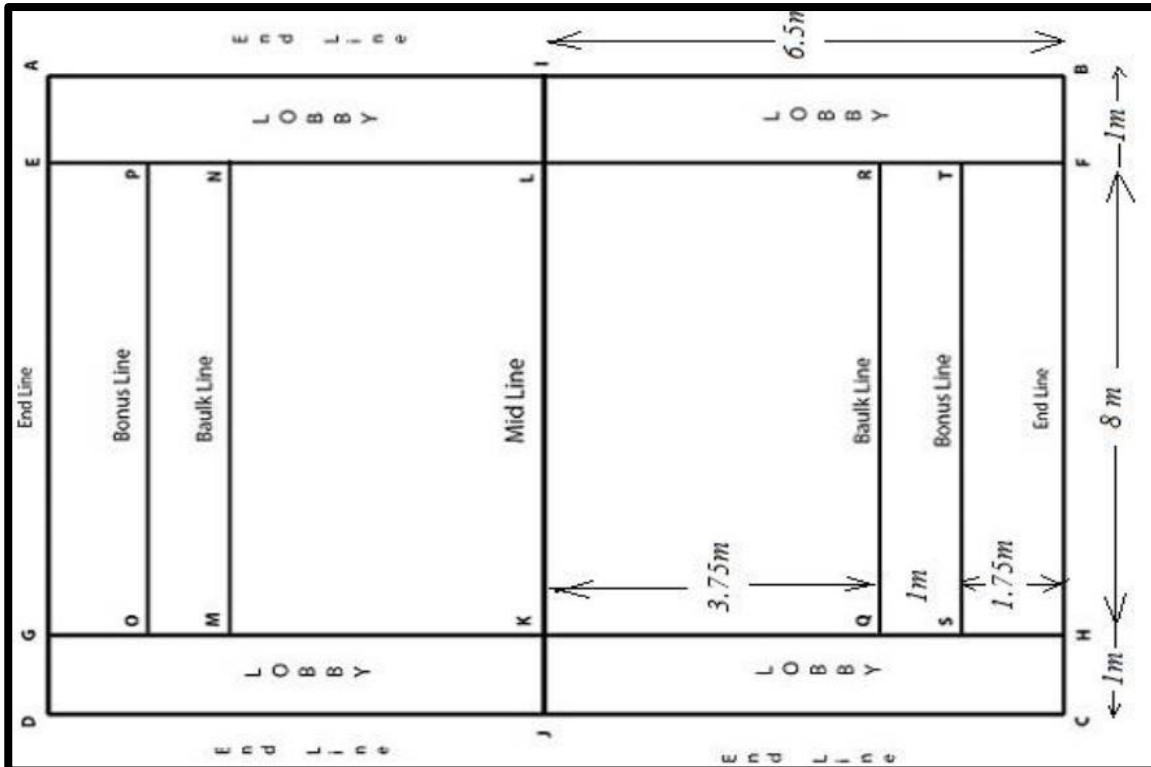

- [Geotagged Photo of Kabaddi Ground- Link](#)



7. Photos of Physical Facilities

A. Photos of Gymkhana and Sport Activities

1. Kabaddi Ground:

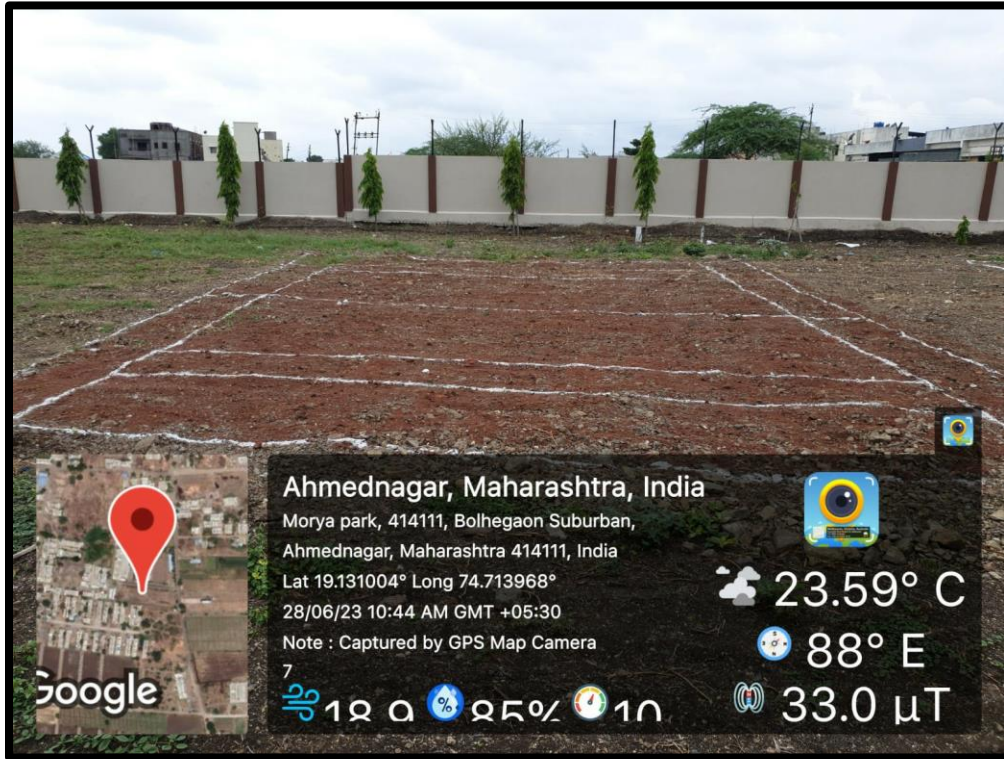

2. Kho-Kho Ground:

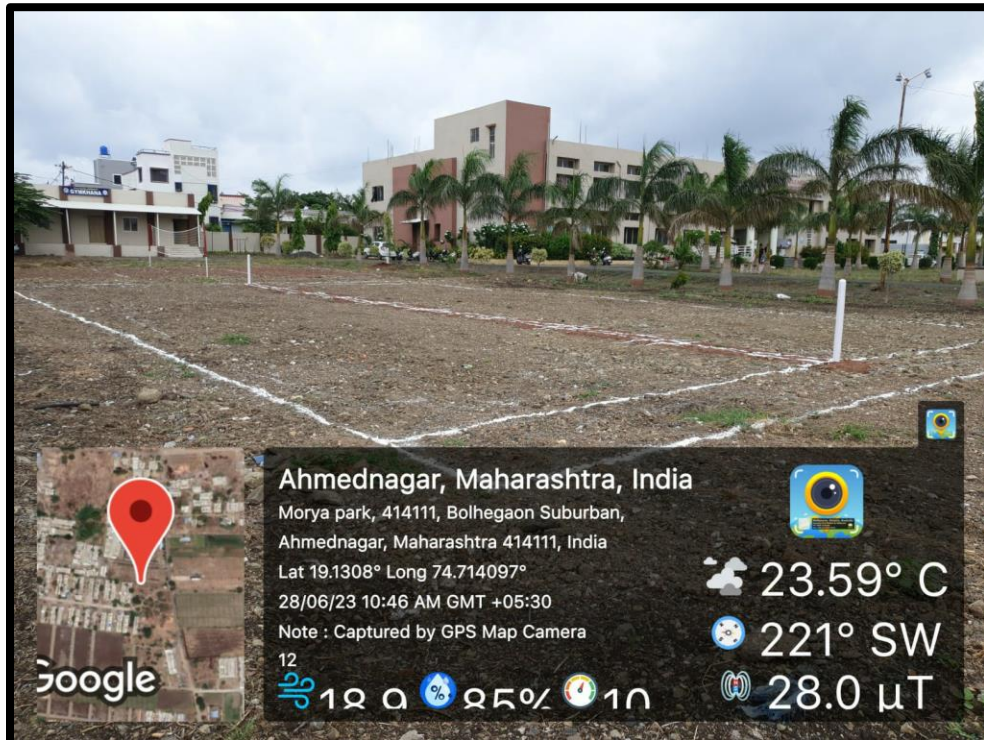



3. Volleyball:

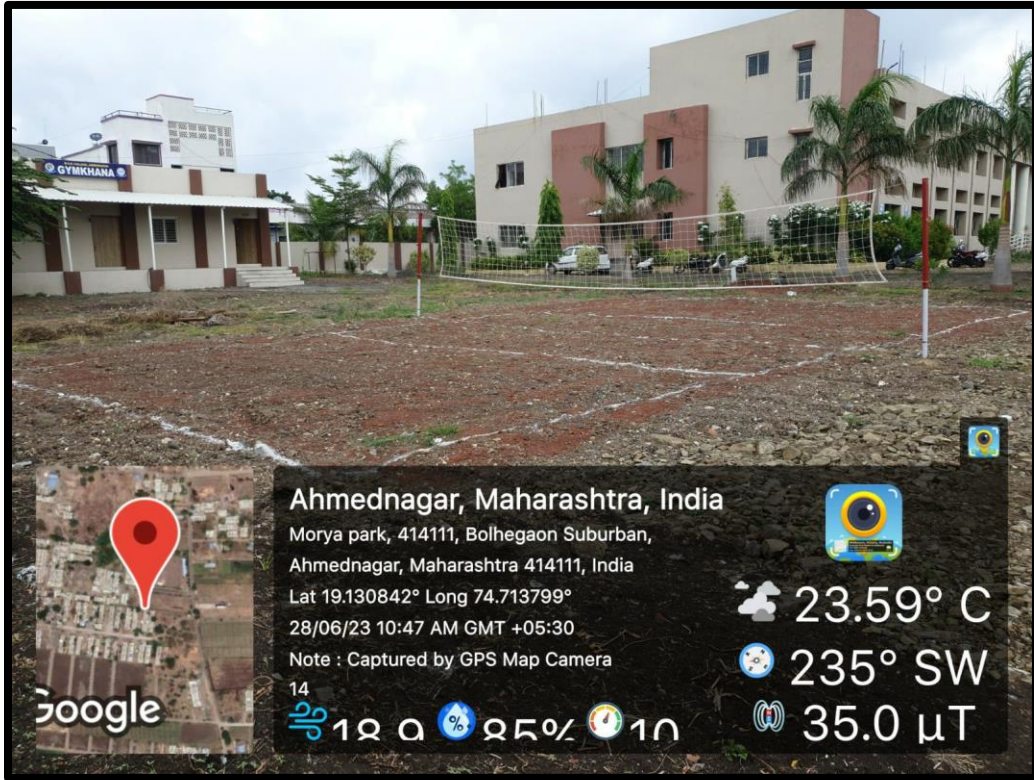



B. Ramps for Divyangjan Student





C. Facilities for Gymkhana sports, games (indoor, outdoor)

Inside View of Gymkhana

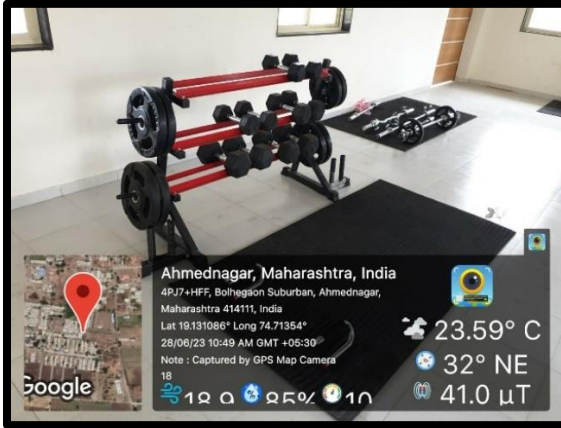

Weight and materials



Indoor Games

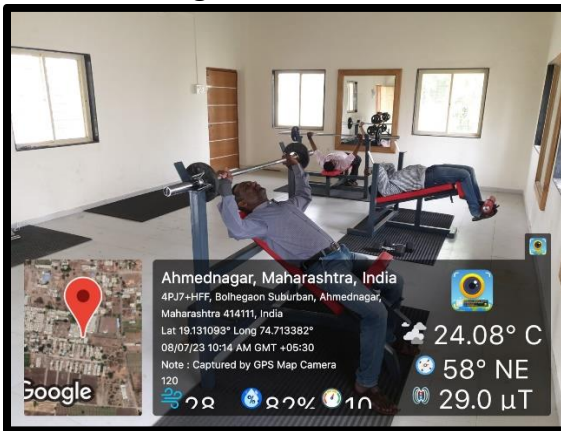

Gymkhana Setup



Inside of gymkhana

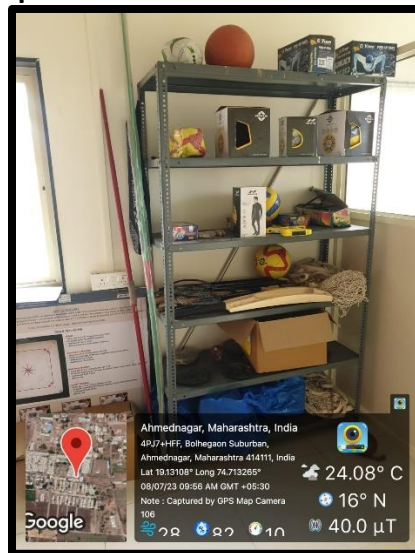

Sport Materials



D. Seating arrangement in campus for student

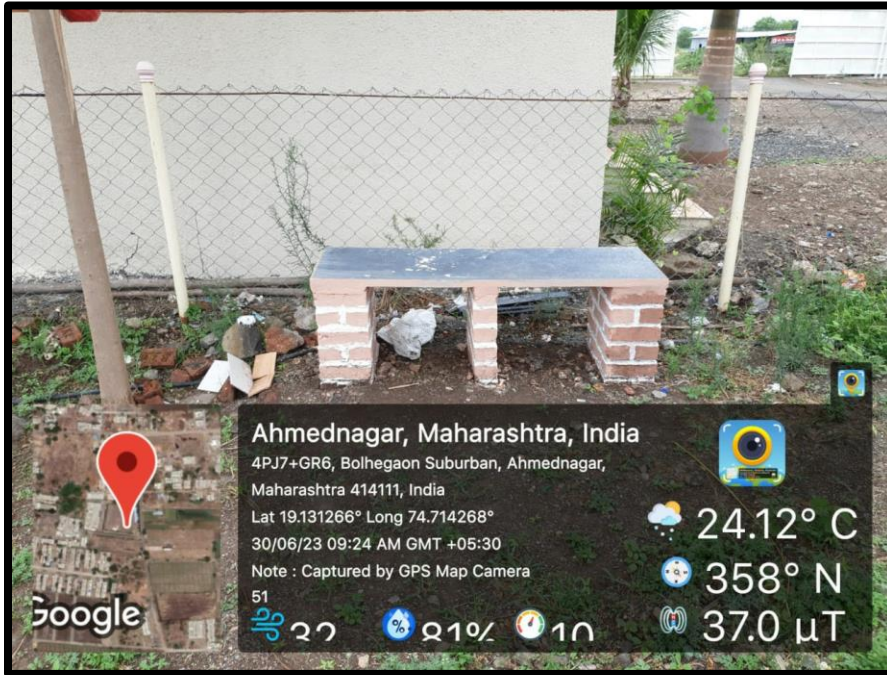



E. Toilet Facility

	For Gents	For Ladies
Urinals	18	
Toilets	12	19



Toilet Facility for Handicap



F. Canteen

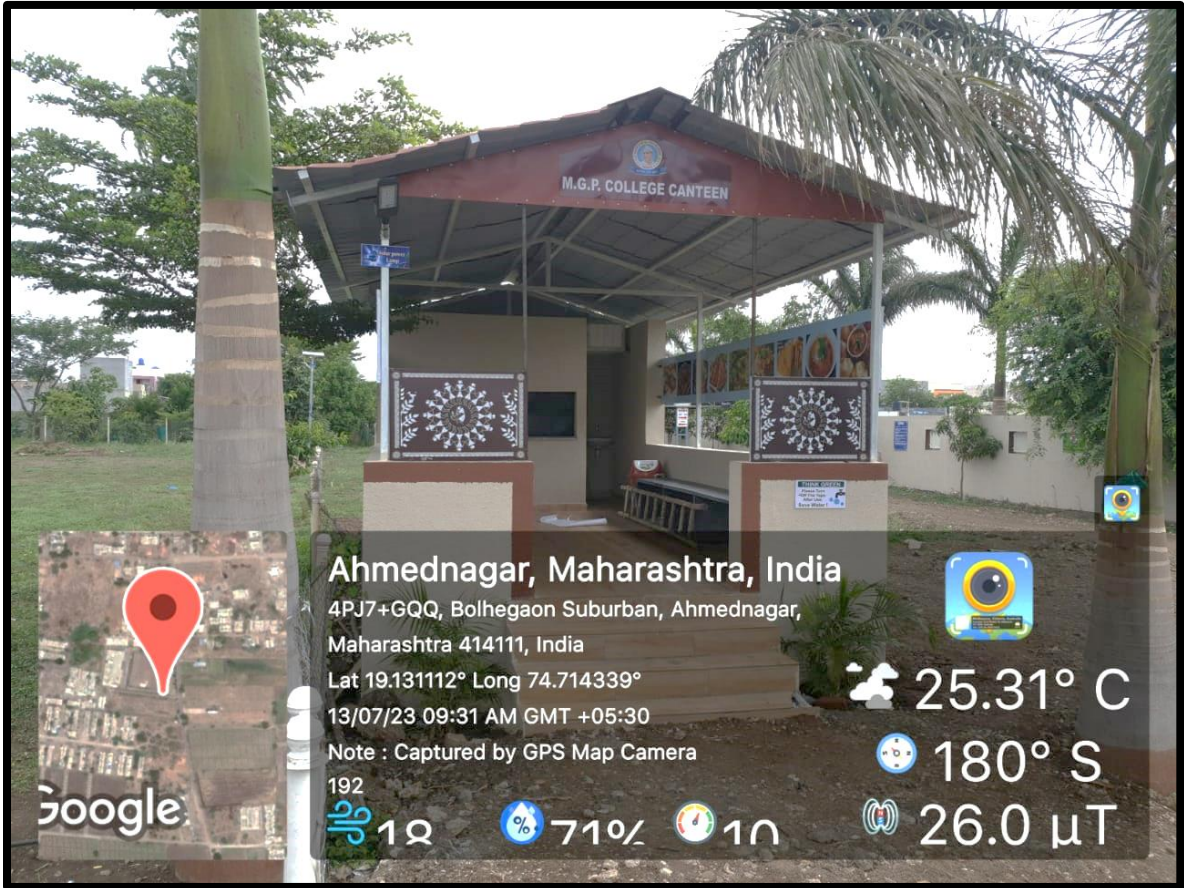



G. Administrative Office



Scholarship and Account office

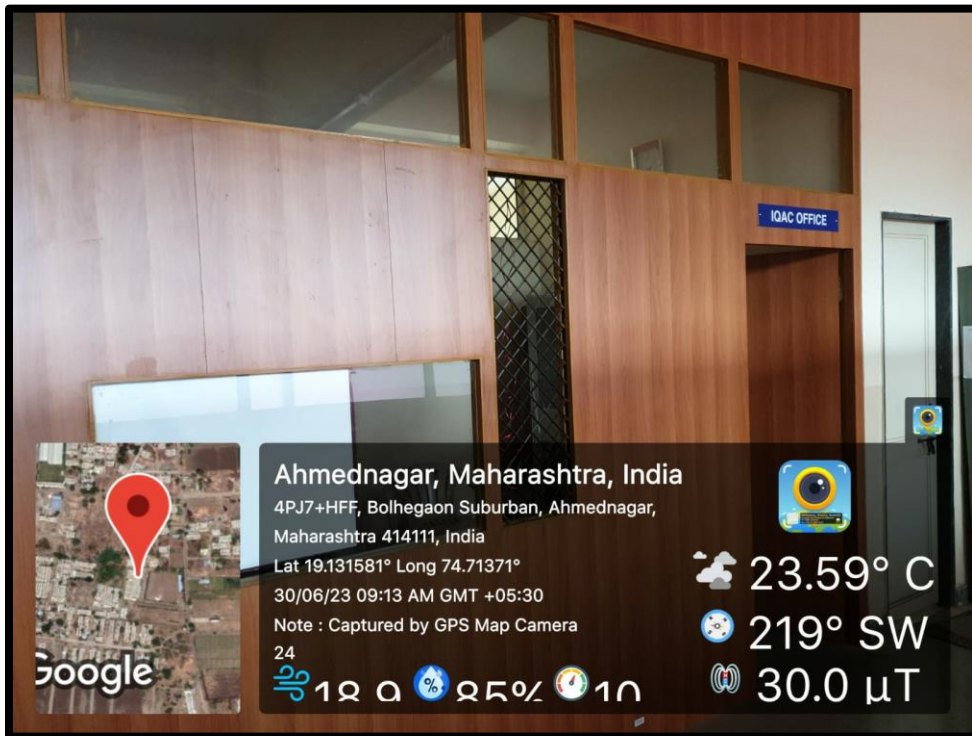

IQAC Office



Entrance View of Administrative Office

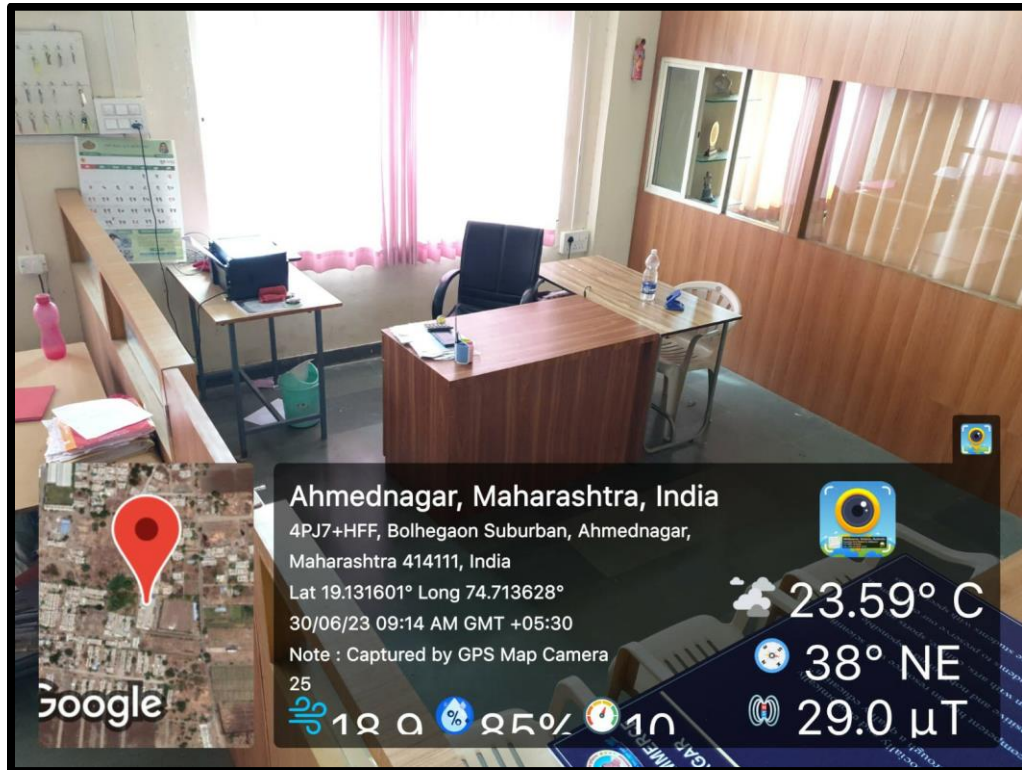

Office Superintendent Cabin



Principal Office

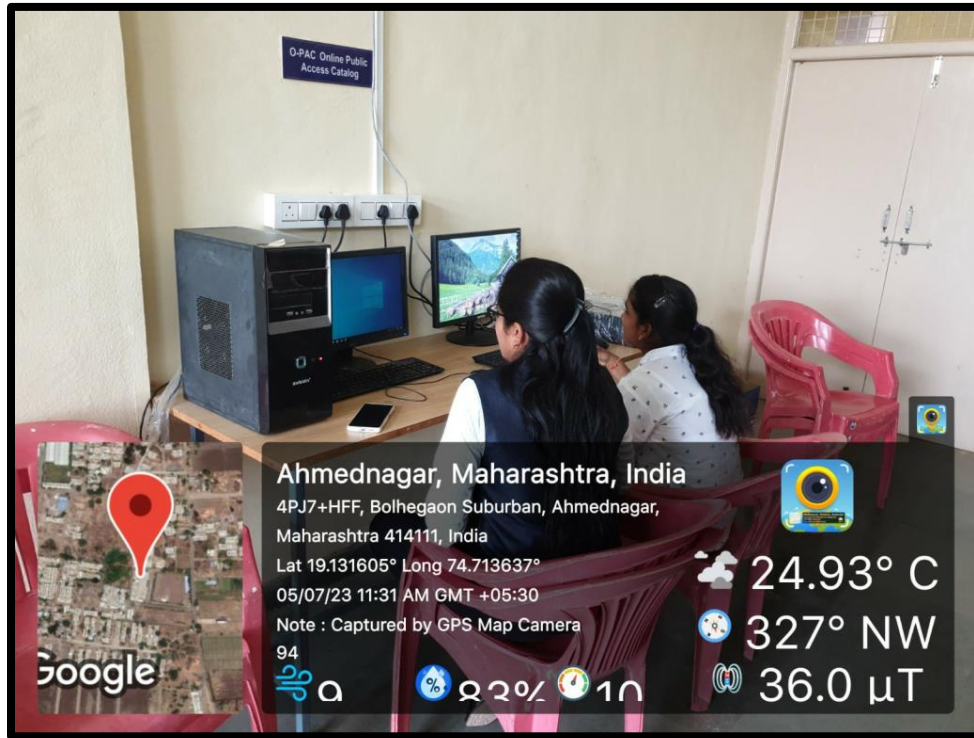

Online Public Access Catalog in Library

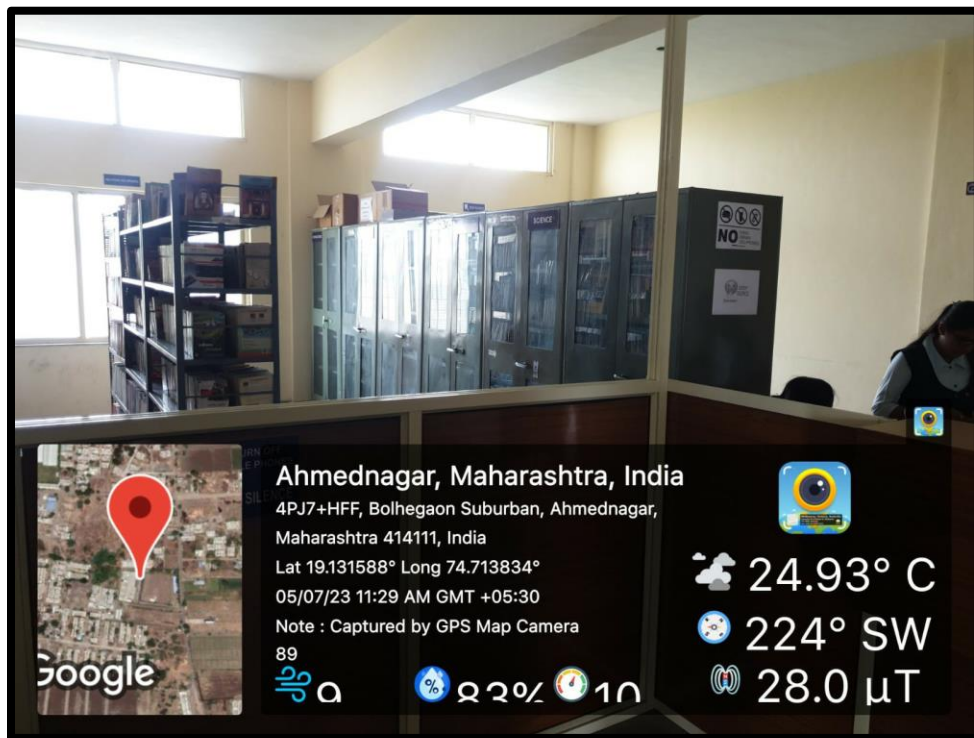

Books Stack



I. Wi-fi facility



Internet Switch in Computer lab



Internet Switch in Principal Cabin



WIFI Router in Administrative Office



Internet Switch in Exam Office



Internet Switch and WIFI Router in Computer Lab



J. ICT facility



Computer Lab



ICT Classroom



Seminar Hall

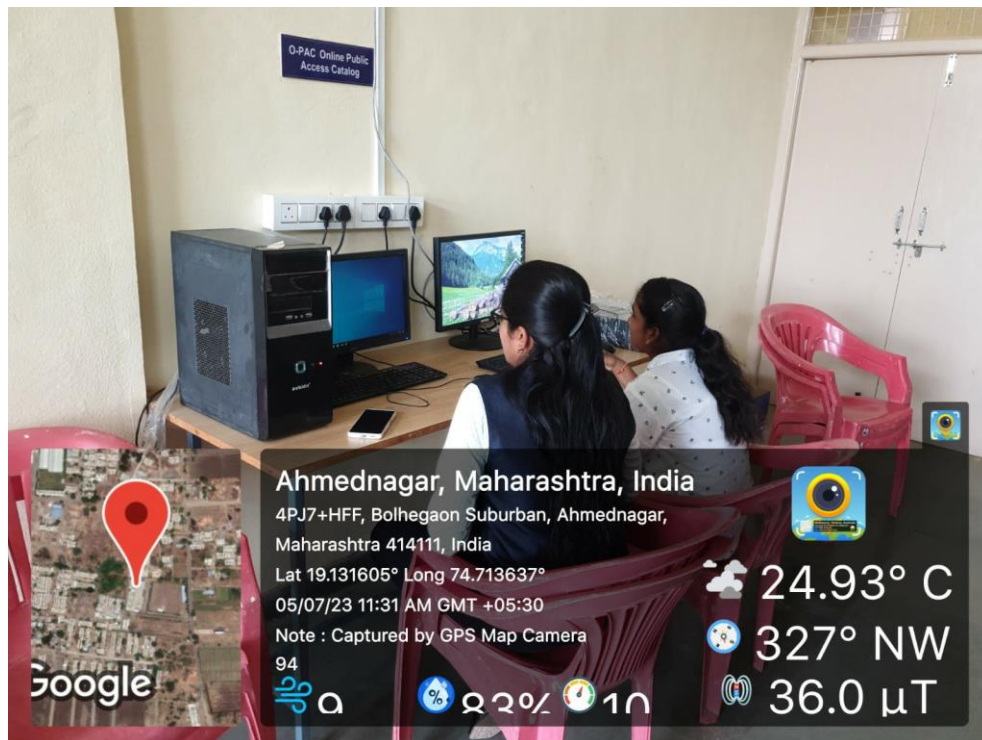

Library



K. CCTV



Camera 2 First Floor Porch

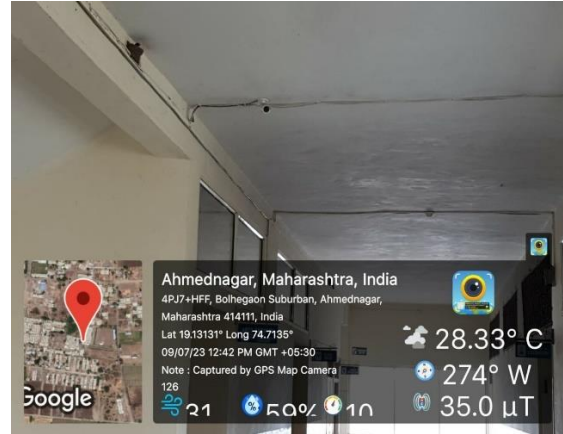

Camera 1 First Floor Porch

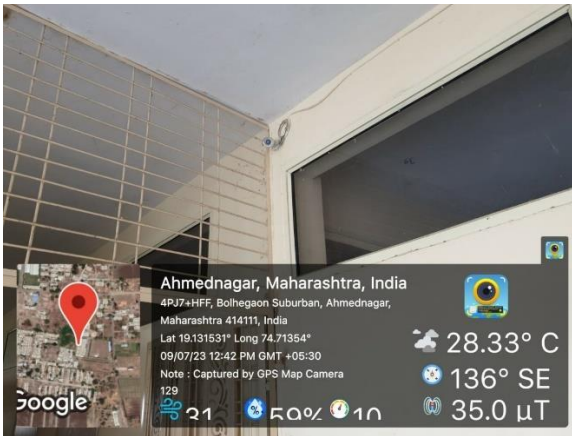

Camera 1 Ground floor Porch



Camera 2 Ground floor Porch

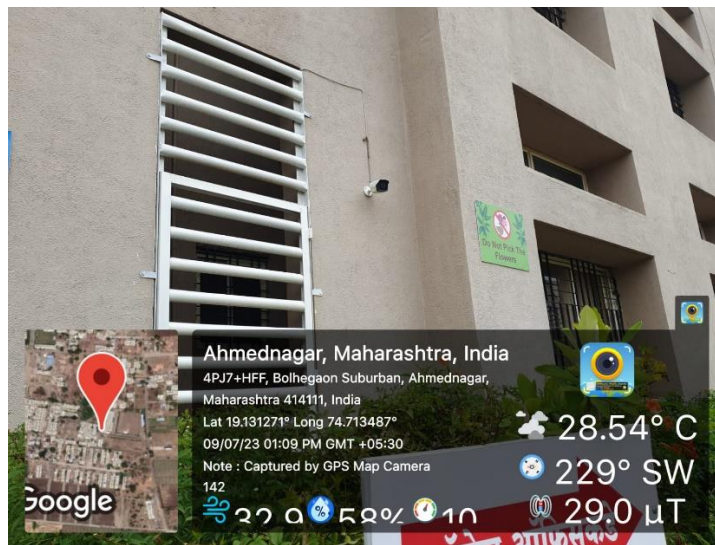

Outside the College Main Building



L. Solar lamp





M. Botanical Garden

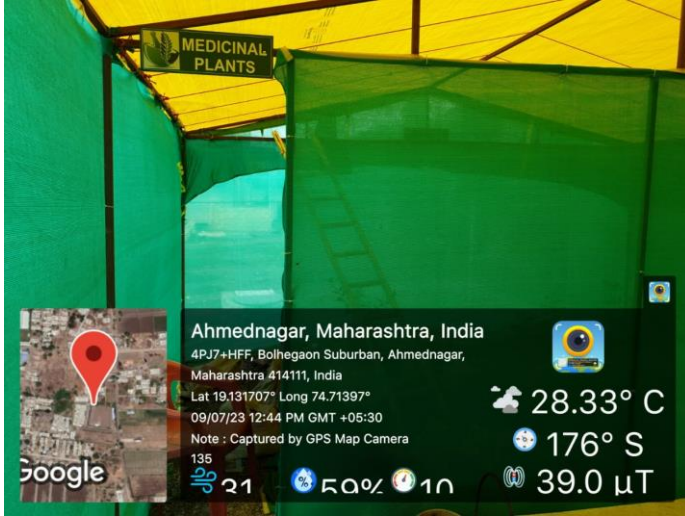

Medicinal Plants

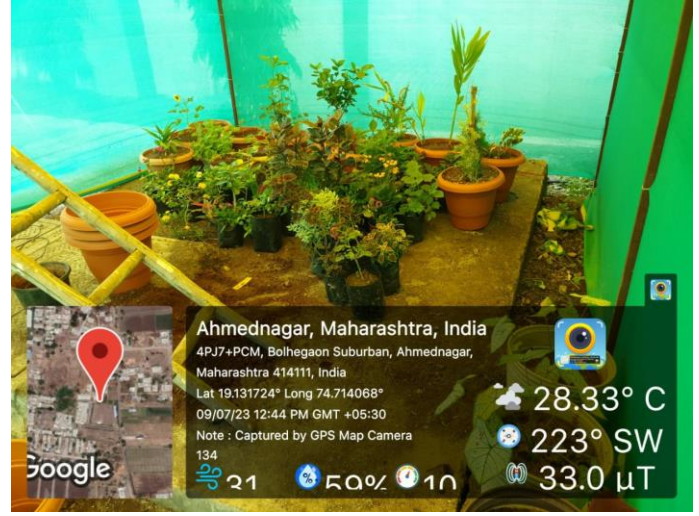

Medicinal Plants Inside View



Cactus Garden



Cactus Garden Inside View

Continued....



Ahmednagar, Maharashtra, India
 4PJ7+GR6, Bolhegaon Suburban, Ahmednagar,
 Maharashtra 414111, India
 Lat 19.131613° Long 74.714096°
 30/06/23 09:21 AM GMT +05:30
 Note : Captured by GPS Map Camera
 24.12° C
 315° NW
 42
 40.0 μT

Botanical Garden Gate

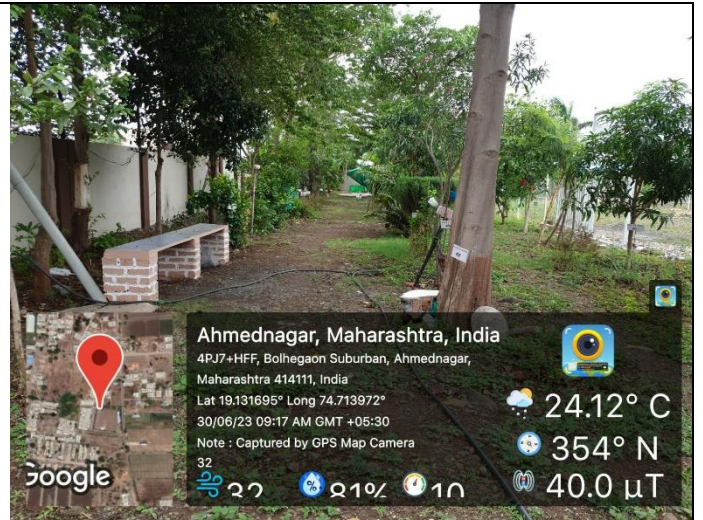

Ahmednagar, Maharashtra, India
 4PJ7+HFF, Bolhegaon Suburban, Ahmednagar,
 Maharashtra 414111, India
 Lat 19.131695° Long 74.713972°
 30/06/23 09:17 AM GMT +05:30
 Note : Captured by GPS Map Camera
 24.12° C
 354° N
 32
 40.0 μT

Inside View



Ahmednagar, Maharashtra, India
 4PJ7+PCM, Bolhegaon Suburban, Ahmednagar,
 Maharashtra 414111, India
 Lat 19.131725° Long 74.714094°
 30/06/23 09:16 AM GMT +05:30
 Note : Captured by GPS Map Camera
 24.12° C
 320° NW
 30
 31.0 μT

View With Name Plates of Plants

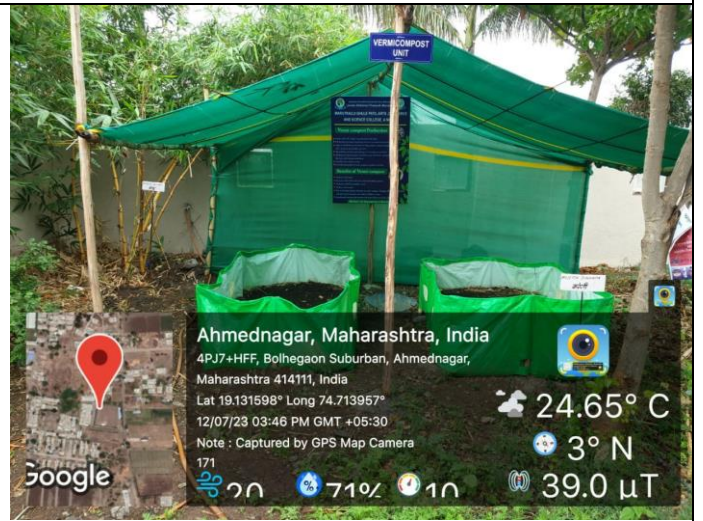

Ahmednagar, Maharashtra, India
 4PJ7+HFF, Bolhegaon Suburban, Ahmednagar,
 Maharashtra 414111, India
 Lat 19.131598° Long 74.713957°
 12/07/23 03:46 PM GMT +05:30
 Note : Captured by GPS Map Camera
 24.65° C
 3° N
 171
 39.0 μT

Vermicompost plant



N. Sick Room

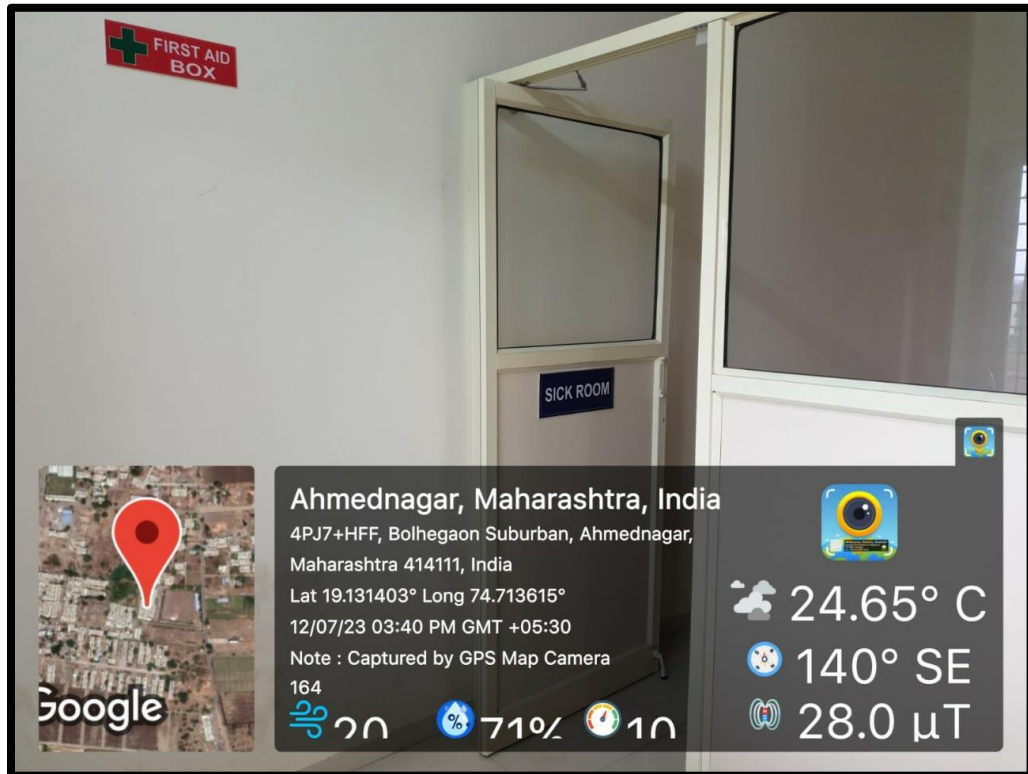
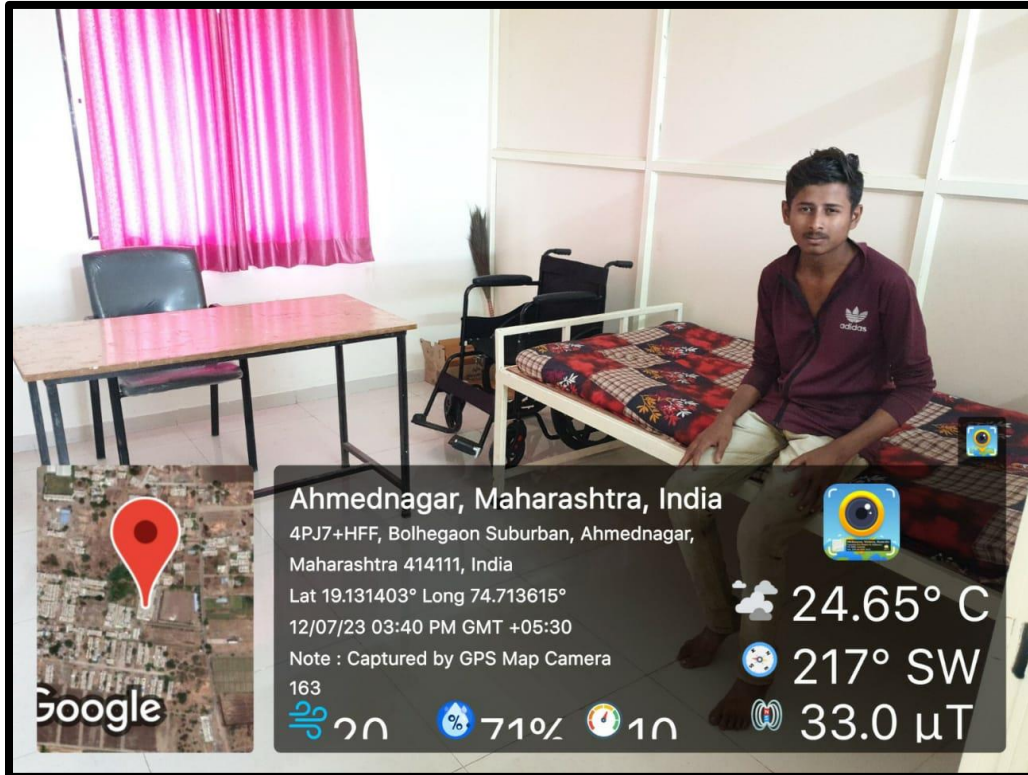



O. Physical Director Cabin

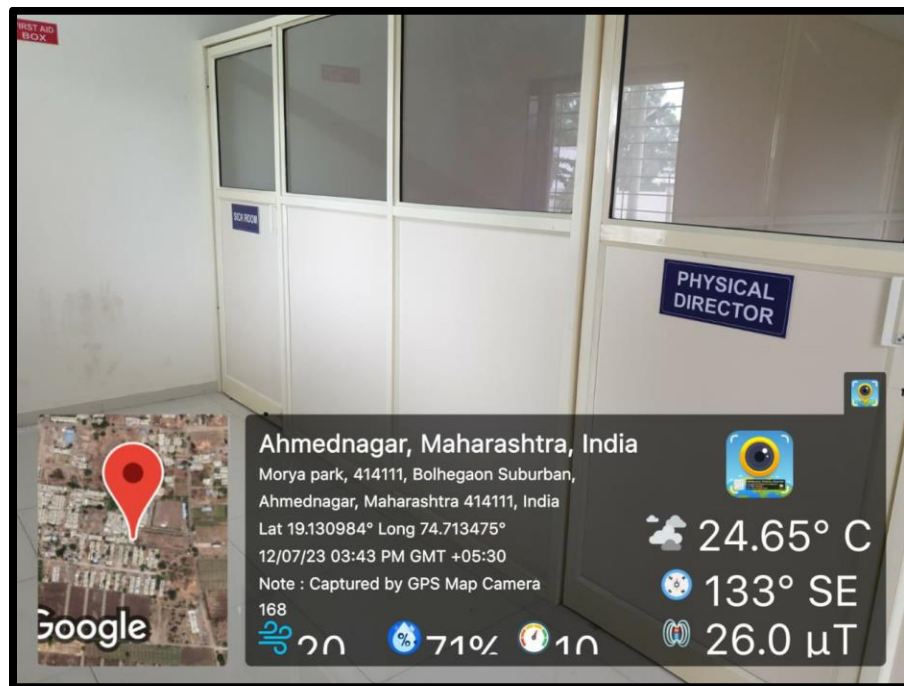
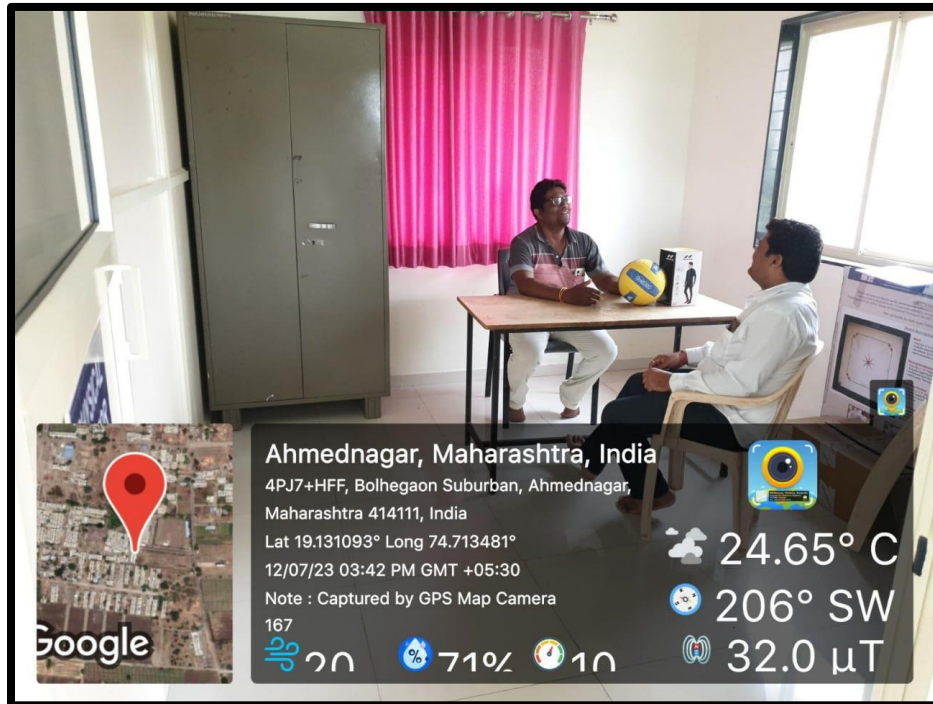



P. Security Cabin

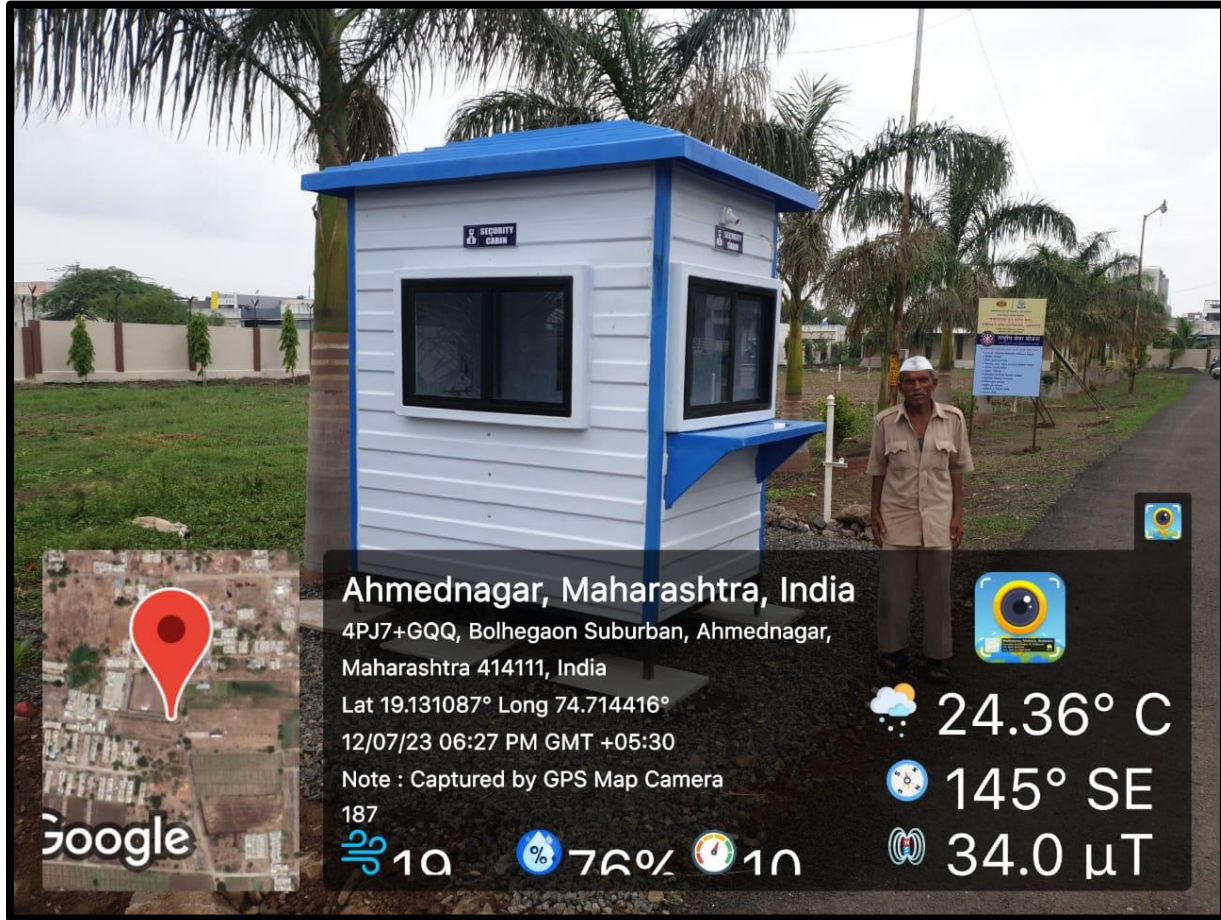



Q. Generator Set



25KVA Generator Set for Power Backup



R. Parking Shed

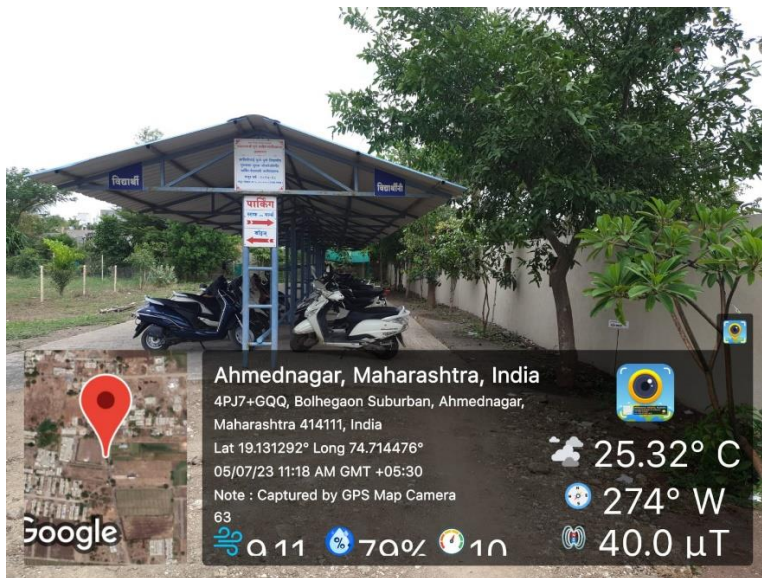



S. Store Room

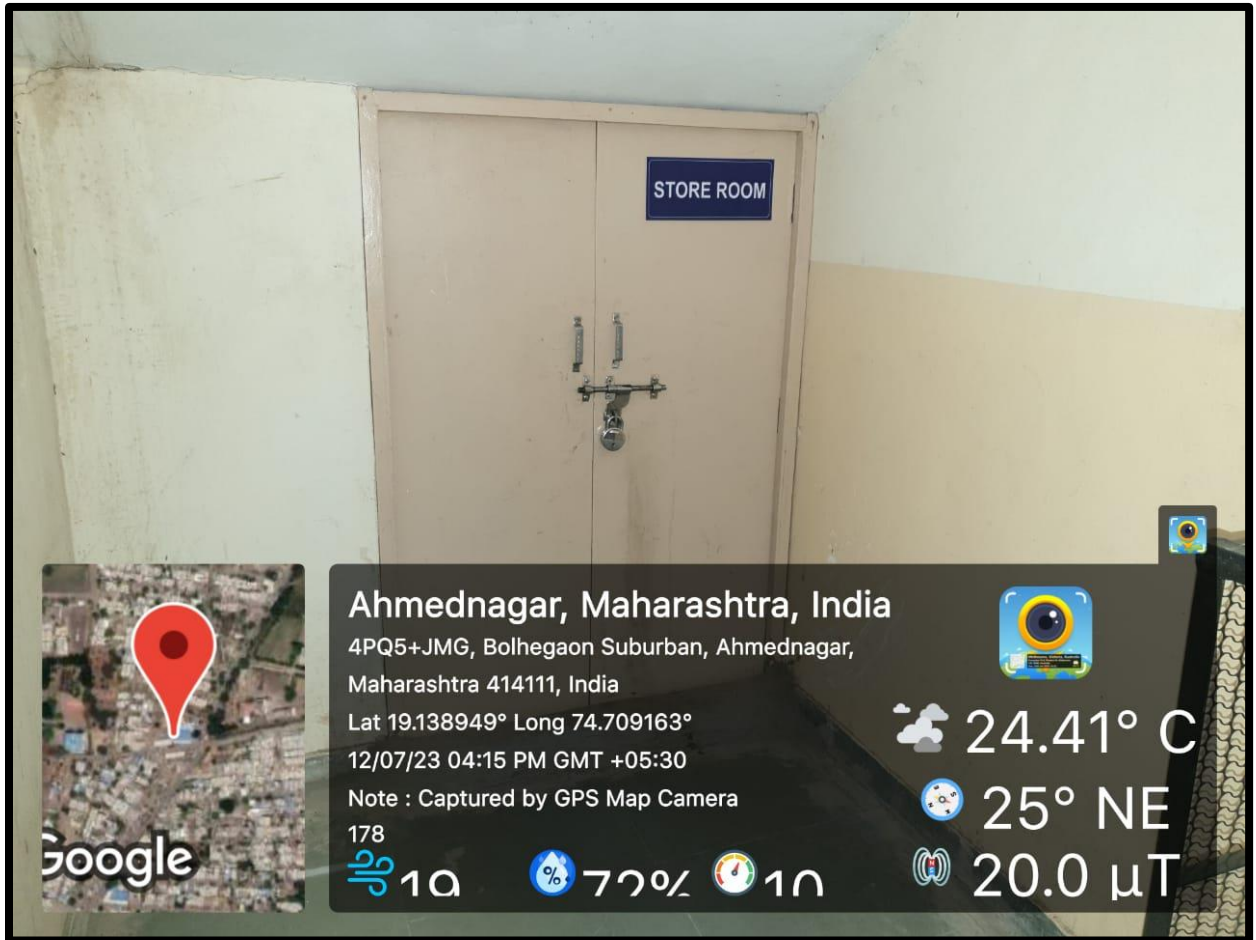



T. Vermicompost

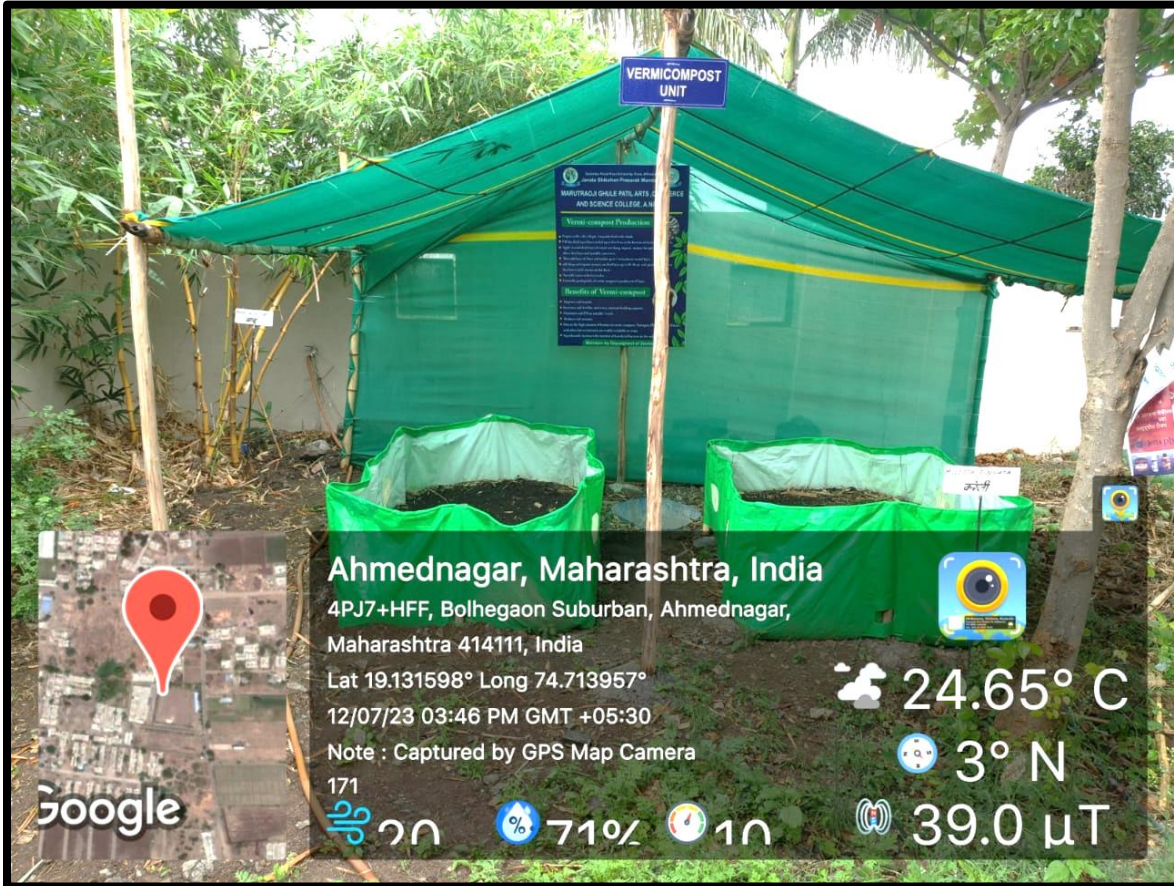



8. Maintenance policy

<https://mgpcollege.com/wp-content/uploads/2023/06/MGP-Maintanance-policy.pdf>

9. Facilities for cultural Activity

I. Seminar Hall





II. Amphitheater





10. Vendors list for maintenance

Sr. No.	Particulars	Name of Vendor	Mobile Number
1.	Electrician	Shri Ajay Sunil Vidhate	9172720465
2.	Plumber	Shri Ganesh Dattatray kavre	7020275884
3.	Welder	Shri Anil Rohidas Banger	9561193748
4.	Gardner	Shri Dattatray Rambhau Kavre	8605705190
5.	Computer Repairer	Shri Bhausahab Ananda Matkar	9822759552
6.	Printer and Toner Repairer	Shri Ashish Balasaheb Gaikwad	8446717022
7.	Painter	Shri Aslam Khanmad Shaikh	8805600543
8.	Carpenter	Shri Anwar bismillah Shaikh	8329296573
9.	Building construction	Shri Ajay Babasaheb Thorat	9503333650
10	Flex and Board Print	Shri Rohit Pravin Kakde	9834723582
11	Fire Extinguisher	Shri Anand Dhanraj Naidu	9284599623
12	Lab Materials	Shri Anand Dhanraj Naidu	9284599623



11. Space for Yoga



On the occasion of Yoga & Dhyana Camp Hon'ble Principal Dr.T.M. Varat, Vice principal Dr.K.R.Pisal, and Asst. Prof. Alfiya Shaikh Hon'ble Principal felicitated to Rajan Kumar.
Academic Year 2018-19



Dhyana & Yoga Training Program organized in academic year -2021-22. Shri S.P.Shinde guided students.